

SAVE FOR HOMEOWNER



JETTA OWNERS MANUAL

FOR ALL LINES AND MODELS

ADVANTAGE | SHOWER BASES
CLASSIC | DESIGNER | ELITE
AFFINITY | COSMO | WALK-IN

(800) 288-7771 | WWW.JETTACORP.COM



THANK YOU

WE'RE THRILLED YOU CHOSE A JETTA BATHTUB!

For almost 40 years, the Jetta name has quietly built a reputation for quality and reliability. Every one of our tubs are built for quality, backed with guarantees, and supported with a lifetime of customer support. Our products are trusted by builders, plumbers, and the customers who use them because we specialize in tub systems and stand behind every one. Complete your personal oasis with a spa pillow for the ultimate at-home spa experience. You can see all of your options at the back of the manuals. We sincerely hope you enjoy your Jetta bathtub for years to come!

If it's not **Stay Hot**, it's not cool.

Take comfort in our EXCLUSIVE warm water guarantee. Designed to draw the maximum amount of heat from the foam insulated JettaWhirl system and transfer it back into the bath water, our Stay Hot Guarantee results in a stable bathing temperature that can actually rise from one to three degrees. That's the kind of guarantee you can make with confidence when you manufacture tubs with quality materials and higher standards from the inside out.



Jetta guarantees that the water in our insulated whirlpool baths will stay within 2 degrees of its original fill temperature for 30 minutes of use without an in-line heater.

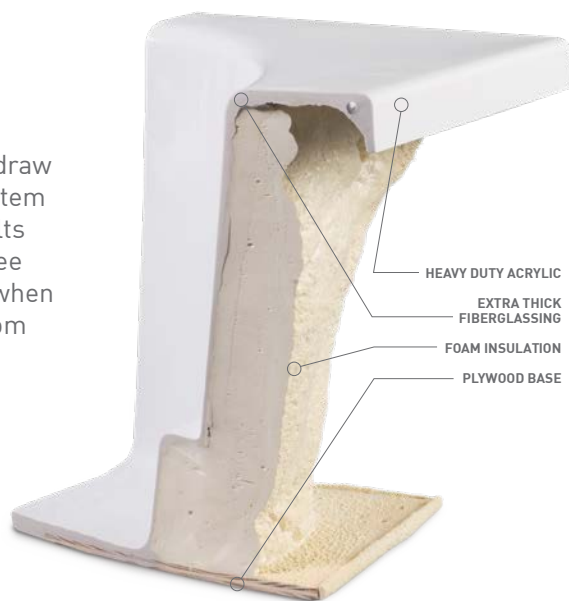

(800) 288-7771 | WWW.JETTACORP.COM

FOLLOW US ON SOCIAL MEDIA FOR PRODUCT UPDATES & OTHER USEFUL INFORMATION!



TABLE OF CONTENTS

SAFETY INSTRUCTIONS	2
OPERATION:	2
ELECTRICAL:	2
USER MAINTENANCE INSTRUCTIONS & CLEANING	3
CLEANING:	3
FLUSHING PROCEDURE:	3
REPAIR:	3
ADVANTAGE OPERATING INSTRUCTIONS	4
OPERATING INSTRUCTIONS FOR WHIRLPOOL BATHS:	4
OPERATING INSTRUCTIONS FOR AIR BATHS:	4
CLASSIC, DESIGNER, & ELITE OPERATING INSTRUCTIONS	5
DIRECTIONAL BODY JETS:	5
ROTATING BACK JETS:	5
AIR BATH INSTRUCTIONS:	6
AFFINITY OPERATING INSTRUCTIONS	8
KEYPAD CONTROL	8
INITIAL POWER CONNECTION	8
WHIRLPOOL ON/OFF	8
AIR BLOWER ON/OFF	8
BATH CONTROL INSTALLATION	9
10 YEAR LIMITED WARRANTY	10
WALK-IN BATH OPERATING INSTRUCTIONS	11
GENERAL INSTRUCTIONS	11
OPERATING INSTRUCTIONS FOR WHIRLPOOL BATHS:	11
OPERATING INSTRUCTIONS FOR AIR BATHS:	11
OPERATING INSTRUCTIONS FOR ACTIVEDRAIN SYSTEM:	11
LIFETIME LIMITED WARRANTY	12
FOR WALK-IN BATHS ONLY	12
TROUBLESHOOTING	13
OWNER'S NOTES	16

SAFETY INSTRUCTIONS

IMPORTANT: INSTRUCTIONS PERTAINING TO A RISK OF FIRE, ELECTRICAL SHOCK, OR INJURY TO PERSONS, READ AND FOLLOW ALL INSTRUCTIONS.

SAVE THESE INSTRUCTIONS.

OPERATION:

1. **DANGER:** To reduce the risk of injury, do not permit children to use unit unless they are closely supervised at all times. Supervision is also required when the bath is used by an elderly or handicapped individual.
2. Use this unit only for its intended use as described in this manual. Do not use attachments not recommended by the manufacturer.
3. Never drop or insert any object into any opening. Do not operate electrical appliances while in or within 5 feet of the bath.
4. Do not operate this unit without the guard over the suction fitting. Long hair must be kept away from the suction screen to avoid entrapment. If entrapment occurs, immediately turn unit off.
5. Do not start pump before unit is filled with water 2" above jets. This will void the warranty.
6. Water level should not exceed the lowest edge of the overflow or controls.
7. The water in a whirlpool should not exceed 40°C (104°F). Water temperatures between 38°C (100°F) and 40°C (104°F) are typically considered safe for healthy adults. Prolonged immersion in hot water may produce hyperthermia. Hyperthermia occurs when the internal temperature of the body reaches a level several degrees above the normal body temperature of 98.6°F. The symptoms of hyperthermia include an increase in the internal temperature of the body, dizziness, lethargy, drowsiness and fainting, which can be fatal. The effects of hyperthermia include failure to perceive heat, failure to recognize the need to exit the tub, unawareness of impending hazard, physical inability to exit the tub, and unconsciousness resulting in the danger of drowning. Lower temperatures are recommended for extended use (exceeding 10-15 minutes) for young children.
8. Exposure to very hot water has the potential to cause fetal damage during pregnancy. Pregnant or possibly pregnant women should limit water temperature to 38°C (100°F). Consult a physician before using.
9. Persons using medication should consult a physician before using a whirlpool. Medications may induce drowsiness, affect heart rate, blood pressure and circulation. **WARNING:** The use of alcohol, drugs or medication can greatly increase the risk of fatal hyperthermia.
10. Persons suffering from obesity or with a medical history of heart disease, low or high blood pressure, circulatory system problems, or diabetes should consult a physician before using a whirlpool.

ELECTRICAL:

1. This unit must be connected to a supply circuit that is protected by a ground-fault-circuit-interrupter (GFCI). Such a GFCI should be provided by the installer and should be tested on a routine basis. To test the GFCI, push the test button. The GFCI should interrupt power. Push the reset button. Power should be restored. If the GFCI fails to operate in this manner, the GFCI is defective. If the GFCI interrupts power without the test button being pushed, there is a ground current flowing indicating the possibility of an electric shock. Do not use this bathtub. Disconnect the unit and have the electrical problem corrected by a qualified service representative before using.
2. Disconnect power before servicing.
3. The motor is supplied with a 30", 14-gauge U.L. approved pigtail. This pigtail is installed at the manufacturer's facility and is factory tested and should not be removed or altered under any circumstances. Removal or alteration of this pigtail will void the warranty. The green lead of the pigtail is connected to the ground terminal inside the terminal compartment. To reduce the risk of electric shock, you must ensure that your electric service or supply panel is properly grounded with a continuous green insulated copper wire equivalent in size to the circuit conductors supplying this equipment, but no smaller than No. 12 AWG.
4. A pressure ground bonding connector is provided on the exterior of the terminal box within this unit to permit connection of a No. 8 AWG solid copper bonding conductor between this unit and all other electrical equipment and exposed metal in the vicinity as needed to comply with local requirements.
5. Install to permit access for servicing (for built-in and custom units).
6. Installer / Owners bear all responsibility to comply with all state and local codes when installing this product.

USER MAINTENANCE INSTRUCTIONS & CLEANING

CLEANING:

Cleaning should be done with a damp cloth and mild dish soap. **NEVER CLEAN YOUR TUB WITH ANY SOLVENTS.** Do not use an abrasive or chemical-based cleanser of any kind. Stubborn stains may be removed by lightly rubbing with a Magic Eraser. The fittings should be wiped off with a damp cloth only. Bubble Bath and bath oils are not recommended for whirlpool, air or combination baths. See dealer for recommended cleaners.

- If you desire additional luster on your bath surface, you may use a good automotive wax recommended for plastic surfaces. Do not wax the floor as this may cause a slipping hazard. Light scratches and abrasions may be removed, and the original gloss restored by using a light buffing compound. Using a damp cloth, rub in small circles until scratches or abrasions are gone and then wipe with a dry cloth until the original gloss is restored.
- Repairs of any kind, if necessary, should be done by qualified acrylic experts.
- Proper installation and maintenance will ensure years of service and make you proud to own a Jetta Corporation bathtub.

It is recommended that your whirlpool or air system be flushed twice per month. More frequent service may be required depending on usage.

FLUSHING PROCEDURE:

1. Fill your bath with hot water
2. Add 2 tablespoons of low-foaming automatic dishwasher detergent (i.e. Cascade)
3. Add 1/2 cup of household bleach to the water
4. Run the whirlpool for a minimum of fifteen minutes
5. Drain bath
6. Refill with cold water and operate the whirlpool for fifteen minutes
7. Drain bath a final time

ALWAYS FILL YOUR TUB WITH WATER 2" ABOVE THE TOP OF THE JETS BEFORE OPERATING YOUR WHIRLPOOL BATH.

To enhance your bathing experience, Jetta recommends using aromatherapy (i.e. inSPAration) as it is specifically designed to keep the system and pipes clear. Oil, bathing salts, and bubble bath solutions are not recommended for use in your tub.

REPAIR:

If any problems develop with your tub, please call your installer, dealer or the factory at (800) 288-7771.

ADVANTAGE OPERATING INSTRUCTIONS

OPERATING INSTRUCTIONS FOR WHIRLPOOL BATHS:

1. The bath should be filled to 2" above the top of the jets BEFORE turning on the pump. The pump is turned on via push button.

Review the specific operating instructions for your bathtub with your installer.



2. When the user enters the bath, the jet direction may be controlled by rotating the eyeball with your finger to the desired location.



3. When bathing is complete, the pump must be turned off and the bath emptied.

PLACE ALL JETS IN A DOWNWARD POSITION TO ALLOW UNIT TO DRAIN PROPERLY.

OPERATING INSTRUCTIONS FOR AIR BATHS:

1. The bath should be filled to 2" above the air injectors BEFORE turning on the pump. The blower may be turned on by use of a 4- function push button. Review the specific operating instructions for your bathtub with your installer.
2. The air system is operated by a multi-function push button air switch. Press once for high speed blower, press again for medium speed, and a third time for low speed. The fourth press will initiate the wave mode, and a fifth press will turn off the system.
3. When bathing is complete, the blower must be turned off and the bath emptied.

NOTE:

The 2-minute purge/dry cycle will automatically begin 20 minutes after use of the air bath feature. If the air bath feature is not used, the purge/dry cycle will not function. It is recommended that the user momentarily turn on the air bath feature to activate the purge/dry cycle anytime the bath is used.

CLASSIC, DESIGNER, & ELITE OPERATING INSTRUCTIONS

THE BATH SHOULD BE FILLED 2" ABOVE THE DIRECTIONAL JETS **BEFORE** TURNING ON THE PUMP.

DIRECTIONAL BODY JETS:

- **To increase the directional jet pressure**, grasp the outer ring of the jet and turn clockwise.
- **To reduce jet pressure**, turn the outer ring counter-clockwise.
- **To adjust the jet direction**, use your finger to position the jet nozzle to the desired location.
- **To remove the jet**, grasp the outer ring of the jet and turn counter clock- wise until the jet clicks, then pull jet out.
- **To install a jet**, insert the jet into the jet housing and turn clockwise until the jet clicks. The jet will pass a point of resistance. *Do not force the jet.*

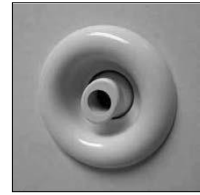

DESIGNER & ELITE SERIES ONLY

ROTATING BACK JETS:

The upper rotating back jets can be shut down for operation at a lower water level.

When shut down, the rotating jets will still have a small flow of water.

- **To increase rotation**, use your finger to position the jet nozzle closer to the outer ring
- **To decrease rotation**, position the jet nozzle closer to the center of the jet

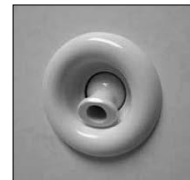

Note: When bathing is complete, the pump must be turned off and the bath emptied. Adjust the inner nozzle portion of all the jets in a downward position while emptying the bath. This allows the bath to drain properly.

CLASSIC, DESIGNER, & ELITE OPERATING INSTRUCTIONS

AIR BATH INSTRUCTIONS:

4 BUTTON AIR BATH CONTROL: STAND ALONE, BLOWER, LIGHT AND SPEED BUTTONS.

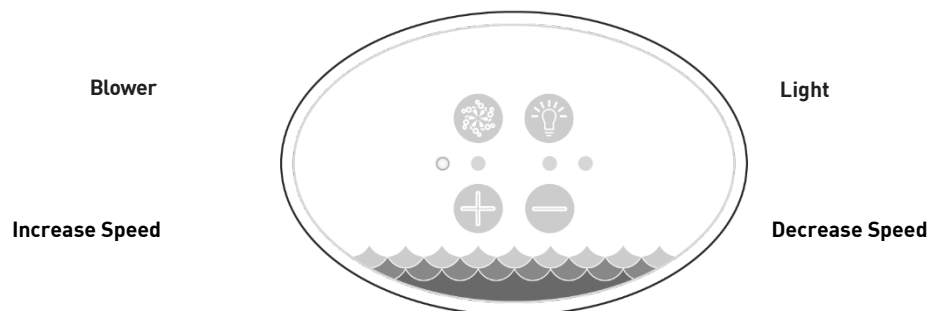

INITIAL POWER CONNECTION

Upon initial connection to power, the LEDs flash as the bath control goes through a self-diagnostic check. Once the LEDs stop flashing, you may use the control.

AIR BLOWER ON/OFF

If the blower is off, press the Blower button once to turn the blower On at the highest speed or, If the blower is On, press the Blower button once to turn the blower Off.

MODES (BEGIN WITH BLOWER TURNED OFF)

Press the Blower button twice to put the Blower into Pulse mode or Press the Blower button three times to put the Blower into Wave mode.

INCREASE/REDUCE BLOWER SPEED

Press and hold the up or down arrow button to increase or decrease the speed smoothly.

LIGHT

If you have a light installed, the light can be controlled independently from all other features. Some lighting options have unique operation for color changes. See the lighting system manual for any special light system that may be installed.

PURGE CYCLE

The Purge Cycle removes standing water from the plumbing and dries the air delivery system. This helps to maintain a sanitary plumbing system.

The Purge Cycle begins 20 minutes after the air blower is turned off.

The Session Timer LED flashes periodically to indicate that a Purge Cycle will soon begin.

Certain actions may cancel the planned Purge Cycle. This is normal. Otherwise, after a number of minutes, the 2-minute Purge Cycle will begin.

When the Purge Cycle ends, all equipment turns off.

CLASSIC, DESIGNER, & ELITE OPERATING INSTRUCTIONS

OPTIONAL HEATED QUIET-FLO BLOWER

Anytime the blower turns on, the heater turns on with it.

LED MESSAGES

SYSTEM ERROR DETECTION

If an error occurs in the bath system, the red ERROR LED will flash.

In addition, the three remaining LEDs stay lit in a specific on/off pattern that reveals a diagnostic code of the error. If this occurs, take note of which of the three lights are on or off. This information will help technical support in diagnosing the error.

SYSTEM RESET

Press and hold the two top buttons simultaneously for 10 seconds to turn off all equipment. Continue to hold the two top buttons 10 seconds longer to restart the system.

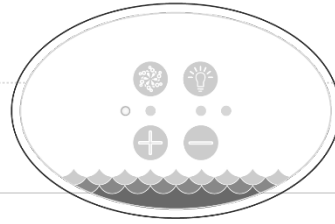

BATH CONTROL INSTALLATION

UNPLUG BLOWER FROM POWER OUTLET

When installing or changing a control panel, unplug the blower from the wall outlet to remove source power. Install the power cord into the wall only after all connections have been made, which include: bath control panel and cables, LED light and cables, and the water detect cable (if equipped).

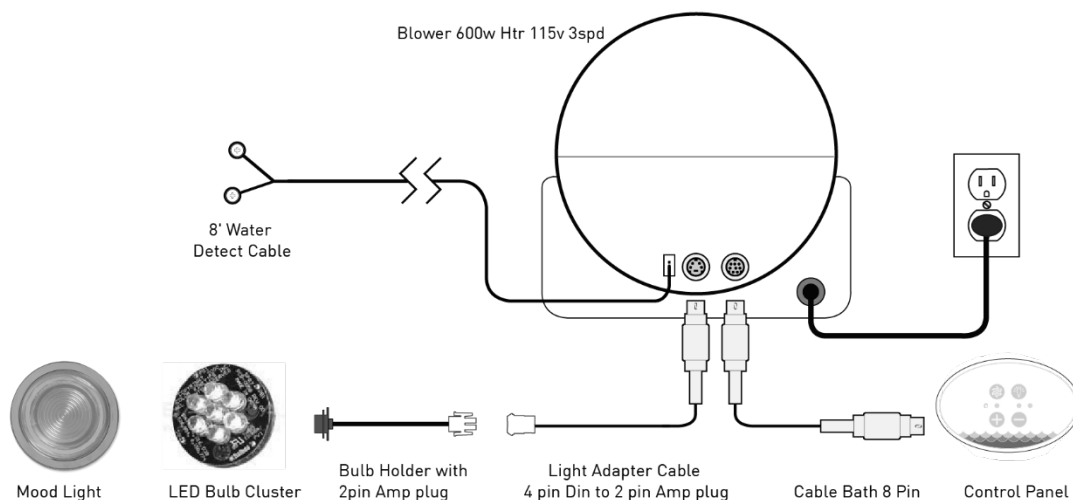

AFFINITY OPERATING INSTRUCTIONS

KEYPAD CONTROL

3 BUTTON AIR BATH CONTROLLER

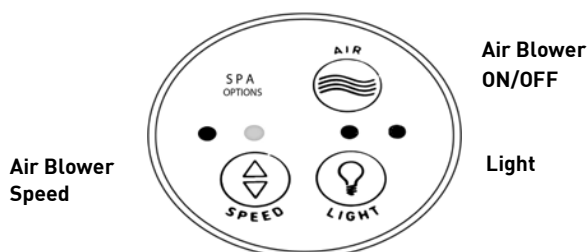

4 BUTTON WHIRLPOOL CONTROLLER

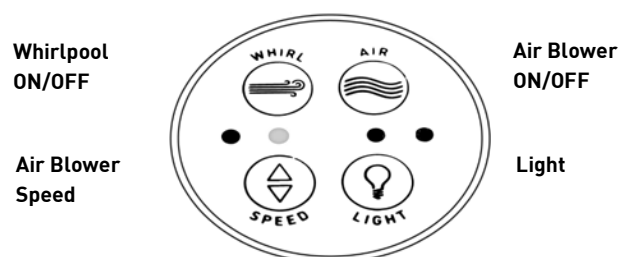

INITIAL POWER CONNECTION

Upon initial connection to power, the LEDs flash as the bath control goes through a self-diagnostic check. Once the LEDs stop flashing, you may use the control.

WHIRLPOOL ON/OFF

The whirlpool bath should be filled to 2" above the jets BEFORE turning on the pump. Turn the pump on or off by pressing the Whirl button on the keypad.

AIR BLOWER ON/OFF

If the blower is off, press the Blower button once to turn the blower On at the highest speed or, If the blower is On, press the Blower button once to turn the blower Off.

MODES (BEGIN WITH BLOWER TURNED OFF)

Press the Blower button twice to put the Blower into Pulse mode or Press the Blower button three times to put the Blower into Wave mode.

INCREASE/REDUCE BLOWER SPEED

Press and hold the up or down arrow button to increase or decrease the speed smoothly.

LIGHT

If you have a light installed, the light can be controlled independently from all other features. Some lighting options have unique operation for color changes. See the lighting system manual for any special light system that may be installed.

PURGE CYCLE

The Purge Cycle removes standing water from the plumbing and dries the air delivery system. This helps to maintain a sanitary plumbing system.

The Purge Cycle begins 20 minutes after the air blower is turned off.

The Session Timer LED flashes periodically to indicate that a Purge Cycle will soon begin.

Certain actions may cancel the planned Purge Cycle. This is normal. Otherwise, after a number of minutes, the 2-minute Purge Cycle will begin.

When the Purge Cycle ends, all equipment turns off.

OPTIONAL HEATED QUIET-FLO BLOWER

Anytime the blower turns on, the heater turns on with it.

LED MESSAGES

SYSTEM ERROR DETECTION

If an error occurs in the bath system, the red ERROR LED will flash.

In addition, the three remaining LEDs stay lit in a specific on/off pattern that reveals a diagnostic code of the error. If this occurs, take note of which of the three lights are on or off. This information will help technical support in diagnosing the error.

SYSTEM RESET

Press and hold the two top buttons simultaneously for 10 seconds to turn off all equipment. Continue to hold the two top buttons 10 seconds longer to restart the system.

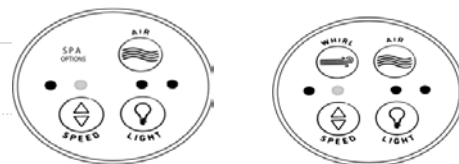

BATH CONTROL INSTALLATION

UNPLUG BLOWER FROM POWER OUTLET

When installing or changing a control panel, unplug the blower from the wall outlet to remove source power. Install the power cord into the wall only after all connections have been made, which include: bath control panel and cables, LED light and cables, and the water detect cable (if equipped)

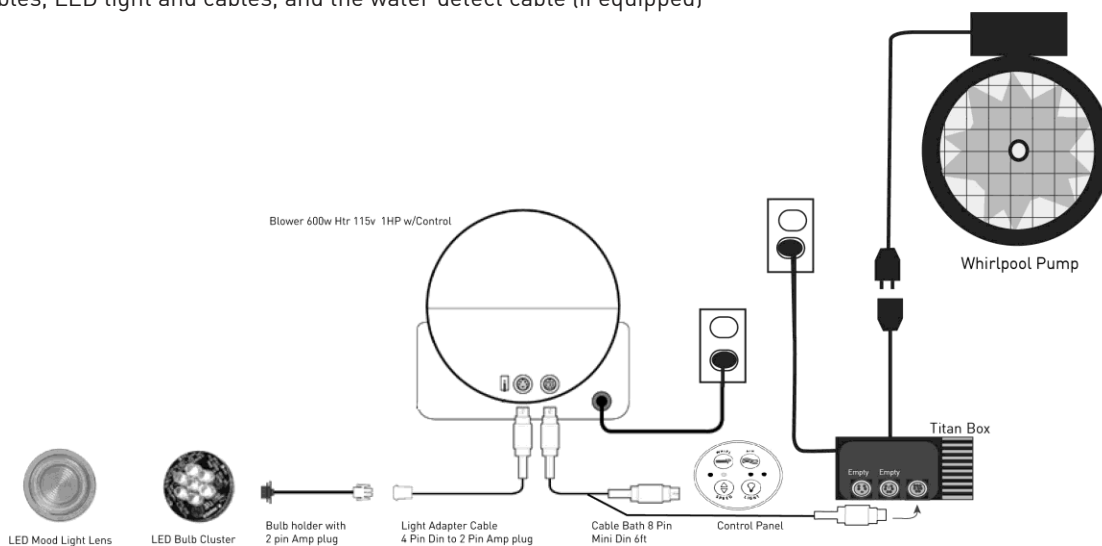



10 YEAR LIMITED WARRANTY

FOR ALL JETTA PRODUCT LINES (EXCLUDING WALK-INS)

This warranty gives the original consumer / purchaser specific legal rights. You may also have additional rights which vary from state to state. All written or implied warranties are limited to the durations expressed below. Any damages, including loss of time, inconvenience, loss of residence, water damage and any other incidental or consequential costs, expense or damage are excluded from this warranty. In no event shall the liability of Jetta Corporation exceed the purchase price of the product. All items must have been installed and maintained in accordance with the Jetta Owner's Manual and installation instructions. All units must be water tested before installation to validate warranty.

Accessories not factory installed are not covered under this warranty.

Covered Products:

Jetta Corporation covers the surface finish and structure of soaking, air, and whirlpool baths plus their support equipment, controls and plumbing equipment for the Jetta J-Line Baths by Jetta products, unless specifically noted by Jetta Corporation at time of purchase.

Structure and Surface Warranty:

The original consumer / purchaser of a Jetta Corporation soaking, air or whirlpool tub receives a limited warranty that includes the following:

- All residential baths are covered by a 10-year limited structural and surface warranty.
- All commercial, hotel or industrial baths are covered with a 1-year limited structural and surface warranty.
- The shell will be free of water loss due to defect and will retain its structural integrity.
- The surface will not fade, crack, blister, or delaminate due to defect. This surface warranty does not apply to fading, cracking, blistering or delamination due to excessive wear, sun fading, improper cleaning practices, or water conditions.

Equipment Warranty:

The original consumer / purchaser of a Jetta Corporation soaking, air or whirlpool tub receives a limited warranty that includes the following:

- All residential baths are covered with a 5-year equipment warranty (equipment includes pump, motor, blower, plumbing parts & fittings and controls) and a 1-year labor warranty.
- All commercial, hotel or industrial baths are covered with a 1-year equipment warranty (equipment includes pump, motor, blower, plumbing parts & fittings and controls) and a 1-year labor warranty.
- Equipment as stated is warranted to be free of defect in workmanship and material for the period noted.

Warranty Limitations:

1. Jetta Corporation reserves the right, at its option to a) repair or replace the defective unit b) repair or replace the defective components, or c) replace with an equal-valued unit.
2. This warranty extends only to the original consumer / purchaser and is not transferable.
3. The structure and surface warranty is valid for ten (10) years for residential baths and one (1) year for commercial, hotel or industrial baths from date of manufacture.
4. The equipment warranty is valid for five (5) years for residential baths and one (1) year for commercial, hotel or industrial baths from date of manufacture.
5. This warranty may not be amended by any other than Jetta Corporation, and this remains the sole warranty for Jetta Corporation J-Line baths.
6. This warranty covers only factory installed accessories.
7. All light bulbs pump seals, air injectors, O-rings, jet trim, pillows, waterfall fill spout, waste & overflows, and skirts are warranted to be free from defects for ninety (90) days from date of purchase.

Warranty Exclusions:

1. Jetta Corporation warranties do not cover defects due to shipping damage, installation errors, use other than non-bathing purposes, abuse, misuse, failure to provide maintenance and /or cleaning as directed in the Owner's Manual, accident or acts of God. Any modifications, alterations or customization made by an unauthorized service representative or without authorization by Jetta Corporation will result in warranty becoming null and void.
2. This warranty does not cover costs associated with installation, removal or installation of replaced unit.
3. This warranty does not include freight charges associated with return of components or unit for repair nor freight charges associated with replacement components or unit.
4. The warranty does not include any costs associated with electrical modifications or plumbing modifications.
5. The foregoing warranty is exclusive and in lieu of all other warranties, including any other warranty of quality, express or implied, and including any warranty of merchantability, or any warranty of fitness for any particular use.

Warranty Service:

In order to make a claim under this warranty, the original consumer / purchaser must notify Jetta Corporation in writing no later than fifteen (15) days from occurrence and must be within the expressed warranty period(s). Please provide a description of the problem and serial number of bath or proof of purchase. Labor includes costs that are deemed typical and customary and must be approved by Jetta Corporation or authorized representative prior to repair in accordance with above conditions and limitations. This warranty excludes any labor incurred due to insufficient access to components, including but not limited to electronics, pumps, blowers and plumbing. Send claim to:

JETTA CORPORATION
WARRANTY SERVICE DEPARTMENT
425 CENTENNIAL BLVD., EDMOND OK 73013
(800) 288-7771 OR WARRANTY@JETTACORP.COM
FAX: (405) 348-9745

With the issuance of this warranty, Jetta Corporation stipulates, and the purchasers agrees, that in the event of litigation is instituted as a result of this limit warranty, said litigation will be controlled by the applicable laws of the State of Oklahoma. The buyer and seller both agree that the appropriate forum and venue for any such litigation will be in Oklahoma County, State of Oklahoma.

WALK-IN BATH OPERATING INSTRUCTIONS

GENERAL INSTRUCTIONS

CAUTION: DO NOT OPERATE THE WHIRLPOOL AIR SYSTEM WITH ANY PARTS OR FITTINGS REMOVED

1. Use this unit only for its intended use as described in the manual.
2. To avoid injury, exercise care when entering or exiting the bathtub the floor may be slippery.
3. Do not use the door as a support while entering or exiting the bathtub, as the door may swing with applied weight and cause injury or damage to the door/hinge.
4. Do not open door until all water has been drained from bathtub.
5. Be careful while exiting tub. Water on the floor or in the tub may cause slippery conditions.
6. Enter your bathtub and latch the door securely. The downward motion of the door level locks and seals the door.
7. Be certain tub drain is open, as the initial water coming from tub spout may be too cold or too hot. Carefully test water temperature by slowly moving hand into the water stream.
8. After adjusting water temperature, move the drain valve handle all the way to close the tub drain.
9. **THE BATH DOOR SHOULD BE LEFT OPEN WHEN THE TUB IS NOT IN USE. THIS ALLOWS THE DOOR SEAL TO RELAX AND RESUME ITS NATURAL SHAPE AND FLEXIBILITY.**
10. **It is especially important to wipe down the door seal and door jamb after each use in order to maintain the integrity of the water seal. In order to keep the door seal and door jamb clean so it does not accumulate dirt or debris of any kind, clean seal and jamb with a mild detergent and warm water using a soft cloth.**

CAUTION: DO NOT USE THE DOOR HANDLE AS SUPPORT WHILE ENTERING OR EXITING THE BATHTUB. USE GRAB BARS ONLY.

OPERATING INSTRUCTIONS FOR WHIRLPOOL BATHS:

1. See Page 5 for Operation of Classic, Designer and Elite Jets

OPERATING INSTRUCTIONS FOR AIR BATHS:

1. See Page 6 & 7 for Operation of Air Baths.

OPERATING INSTRUCTIONS FOR ACTIVE DRAIN SYSTEM:

DESCRIPTION OF OPERATION

1. The Jetta ActiveDrain is a pump assisted drain system that significantly reduces the drain time on a walk-in tub so the bather does not remain seated in the tub for an extended period while the tub drains.
2. The ActiveDrain is operated by an air switch mounted on the deck of the tub. Once the bather has completed their bath, they will depress the air switch, activating the drain pump. For fastest draining, the floor drain should remain closed while the ActiveDrain is in operation.
3. Once the water level is below the tub door, the ActiveDrain system can be turned off. The bather can then exit the tub and open the floor drain to remove the remaining bath water.
4. The ActiveDrain system requires a separate GFI protected 20-amp electrical circuit.

CONTROLS LOCATION:

Combo Hydrotherapy

Air Control

Whirlpool

Active Drain

**Air Hydrotherapy**

Air Control

Active Drain

**Whirlpool Hydrotherapy**

Whirlpool

Active Drain





LIFETIME LIMITED WARRANTY

FOR WALK-IN BATHS ONLY

This warranty gives the original consumer / purchaser specific legal rights. You may also have additional rights which vary from state to state. All written or implied warranties are limited to the durations expressed below. Any damages, including loss of time, inconvenience, loss of residence, water damage and any other incidental or consequential costs, expense or damage are excluded from this warranty. In no event shall the liability of Jetta Corporation exceed the purchase price of the product. All items must have been installed and maintained in accordance with the Jetta Owner's Manual and installation instructions. All units must be water tested before installation to validate warranty. **Accessories not factory installed are not covered under this warranty.**

Covered Products:

Jetta Corporation covers the shell, door and door seal of soaking, air, and whirlpool Walk-In baths plus their support equipment, controls and plumbing equipment for the Jetta Walk-In baths, unless specifically noted by Jetta Corporation at time of purchase.

Shell, Door and Seal Warranty:

- The original consumer / purchaser of a Jetta Corporation soaking, air or whirlpool receives a limited warranty that includes the following:
- All residential Walk-In baths are covered by a lifetime limited shell, door and door seal warranty. Manufacturer warrants the door seal for the life of the unit under normal use and conditions. This warranty shall not apply to any failure resulting from negligence, abuse, misuse, misapplication, alteration or modification or improper maintenance. The replacement door seal will be issued to the end user and it will be the responsibility of the end user to determine the means of installation. Manufacturer will not be liable for any incidental expenses or material charges in connection with removal or replacement of the door seal.
- All commercial, hotel or industrial baths are covered with a 1-year limited structural and surface warranty.
- The shell will be free of water loss due to defect and will retain its structural integrity.
- The surface will not fade, crack, blister, or delaminate due to defect. This surface warranty does not apply to fading, cracking, blistering or delamination due to excessive wear, sun fading, improper cleaning practices, or water conditions.

Equipment Warranty:

- The original consumer / purchaser of a Jetta Corporation soaking, air or whirlpool receives a limited warranty that includes the following:
- All residential baths are covered with a 10-year equipment warranty (equipment includes pump, motor, blower, plumbing parts & fittings and controls) and a 1-year labor warranty.
- All commercial, hotel or industrial baths are covered with a 1-year equipment warranty (equipment includes pump, motor, blower, plumbing parts & fittings and controls) and a 1-year labor warranty.
- Equipment as stated is warranted to be free of defect in workmanship and material for the period noted.

Warranty Limitations:

1. Jetta Corporation reserves the right, at its option to a) repair or replace the defective unit b) repair or replace the defective components, or c) replace with an equal-valued unit.
2. This warranty extends only to the original consumer / purchaser and is not transferable.
3. The shell, door and door seal warranty is valid for the lifetime of the residential baths and one (1) year for commercial, hotel or industrial baths from date of manufacture.
4. The equipment warranty is valid for five (5) years for residential baths and one (1) year for commercial, hotel or industrial baths from date of manufacture.
5. This warranty may not be amended by any other than Jetta Corporation, and this remains the sole warranty for Jetta Corporation Walk-In baths.
6. This warranty covers only factory installed accessories.
7. All light bulbs, pump seals, air injectors, O-rings, jet trim, pillows, and waste & overflows are warranted to be free from defects for (1) year from date of purchase.

Warranty Exclusions:

1. Jetta Corporation warranties do not cover defects due to shipping damage, installation errors, use other than non-bathing purposes, abuse, misuse, failure to provide maintenance and /or cleaning as directed in the Owner's Manual, accident or acts of God. Any modifications, alterations or customization made by an unauthorized service representative or without authorization by Jetta Corporation will result in warranty becoming null and void.
2. This warranty does not cover costs associated with installation, removal or installation of replaced unit.
3. This warranty does not include freight charges associated with return of components or unit for repair nor freight charges associated with replacement components or unit.
4. The warranty does not include any costs associated with electrical modifications or plumbing modifications.
5. The foregoing warranty is exclusive and in lieu of all other warranties, including any other warranty of quality, express or implied, and including any warranty of merchantability, or any warranty of fitness for any particular use.

Warranty Service:

In order to make a claim under this warranty, the original consumer / purchaser must notify Jetta Corporation in writing no later than fifteen (15) days from occurrence and must be within the expressed warranty period(s). Please provide a description of the problem and serial number of bath or proof of purchase. Labor includes costs that are deemed typical and customary and must be approved by Jetta Corporation or authorized representative prior to repair in accordance with above conditions and limitations. This warranty excludes any labor incurred due to insufficient access to components, including but not limited to electronics, pumps, blowers and plumbing. Send claim to:

JETTA CORPORATION

WARRANTY SERVICE DEPARTMENT

425 CENTENNIAL BLVD., EDMOND OK 73013

(800) 288-7771 OR WARRANTY@JETTACORP.COM

FAX: (405) 348-9745

With the issuance of this warranty, Jetta Corporation stipulates, and the purchasers agrees, that in the event of litigation is instituted as a result of this limit warranty, said litigation will be controlled by the applicable laws of the State of Oklahoma. The buyer and seller both agree that the appropriate forum and venue for any such litigation will be in Oklahoma County, State of Oklahoma.

TROUBLESHOOTING**WHY WILL MY JET MOTOR NOT TURN ON OR OFF?**

The GFCI could be tripped. Confirm that the receptacle is working by plugging in a hairdryer or light. If the receptacle is operational, check to ensure that the red tubing is attached firmly to the bottom of the On/Off switch button body as well as to the back of the motor. The On/Off button is operated by a puff of air traveling down this line.

WHY IS THE SAME AMOUNT OF WATER NOT COMING OUT OF ALL MY JETS?

All Elite, Designer, Classic and Walk-In tubs have jets with adjustable water volume control to provide specific intensity to each area of the body. The intensity can be controlled by turning the jet to the right for increased water flow or to the left for decreased water flow. Please note that our Advantage and Affinity lines do not have adjustable water volume jets.

CAN I ADJUST THE WHIRL PATTERN COMING FROM THE JETS ON THE BACK OF MY TUB?

Jetta Designer and Elite baths come standard with rotational jets at the back of the tub. These jets are designed to disperse water in a whirl pattern. To reduce the whirl pattern, use your finger to adjust the center of the jet nozzle to the center of the jet body. To increase the whirl pattern, move the jet nozzle to the outer ring of the jet body. Please note that our Classic, Walk-In, Advantage and Affinity lines do not have rotational jets.

WHY DOES THE WATER FLOW NOT INCREASE THROUGH JETS EVEN THOUGH I AM ADJUSTING THEM?

There could be debris caught in the jet. The jet body on our Classic, Designer, Elite and Walk-In tubs can be removed by rotating to the left until the tabs clear the openings. When reinstalling the jet, insert the tabs into the openings and turn to the right until you hear the jet click into place. Please note that the jets on our Affinity and Advantage lines are unable to be adjusted and/or removed for cleaning.

CAN I REMOVE MY JETS FOR CLEANING?

The jets in Jetta's Classic, Designer, and Elite tubs can be removed and placed in the dishwasher for cleaning. To remove the jets, turn the outer ring counter clockwise past the point of resistance until you hear a click. Pull the jet straight out to remove. To reinstall the jet, insert the jet body into the housing and turn to the right until you hear a click.

CAN I USE EPSOM OR BATH SALTS, BUBBLE BATH, OR BATH OILS IN MY TUB?

We do not recommend using salts with the whirlpool or air feature as the salt crystals may get stuck in the jets, air holes, plumbing lines or pump. Additionally, the acrylic may discolor due to use of bath salts.

We recommend using only bubble bath that is water soluble with the soaker hydrotherapy only so as not to leave a residue in the plumbing or air lines of your tub. We do not recommend using bubble bath or any oil-based bath products while your whirlpool or air system is in use.

HOW DO I CLEAN THE ACRYLIC SURFACE OF MY BATHTUB?

Use a soft cloth and liquid dishwashing detergent to clean the surface of the tub. A Magic Eraser works well on stubborn marks.

For an additional luster on your bath surface, you may use a high quality automotive wax recommended for plastic surfaces. Do not wax the floor as this may cause a slipping hazard. Light scratches and abrasions may be removed, and the original gloss restored by using a light buffing compound. Using a damp cloth, rub in small circles until scratches or abrasions are gone and then wipe with a dry cloth until the original gloss is restored.

Repairs of any kind, if necessary, should be done by a qualified acrylic expert.

TROUBLESHOOTING (CONTINUED)

WHY WILL MY AIR BLOWER NOT TURN ON?

The GFCI could be tripped. Confirm that the receptacle is working by plugging in a hairdryer or light. If the outlet is operational, unplug the blower from the GFCI outlet under your tub. Ensure that the black cable is securely fastened to the back of the keypad as well as the back side of the blower. The black cable needs to be plugged into the far right opening as you are facing the back of the blower. Look into the plug on the cable and confirm there are no bent pins inside the plug. Plug the blower back into the GFCI outlet. Reset the keypad by pressing and holding the top two buttons simultaneously for 10 seconds. If the reset was successful, all the lights on the keypad should be off after the initialization sequence concludes.

HOW DO I ADJUST THE SPEED OF THE BUBBLES ON MY AIR TUB?

The speed adjustment is located on your keypad. Press and hold the + or – keys to increase or decrease the speed of the bubbles.

WHY IS MY AIR BLOWER NOT RUNNING AT AN EVEN SPEED?

Jetta air tubs come standard with three modes. Pressing the blower button on your keypad once will give you Continuous Mode. Pressing the blower button twice will give you Pulse Mode. Pressing the blower button three times will give you Wave Mode.

WHY DOES MY AIR BLOWER TURN ON AFTER I AM OUT OF THE BATH?

Jetta air tubs come equipped with an automatic purge or dry cycle. This keeps the injector lines clean and dry. The cycle is initiated automatically 20 minutes after use and has a cycle time of 2 minutes.

SHOULD I RUN THE PURGE CYCLE EVEN IF I DO NOT USE THE AIR BLOWER?

Yes. Jetta recommends that you turn the blower on then back off to set the purge cycle to ensure that the lines stay clean and dry.

WHAT SHOULD I DO IF THE LIGHT IN MY AIR TUB WILL NOT TURN ON?

The light on air or combo tubs is operated by the keypad. Check to ensure that the gray cable coming from the back of the light cup is plugged into the middle outlet on the back of the blower.

**If unit is within the limited factory warranty,
Contact Jetta Corporation at
(800) 288-7771 with your purchasing information on-hand so we may serve you better.**

**For additional troubleshooting tips, visit
WWW.JETTACORP.COM/FAQs**

OWNER'S NOTES

ROLL OUT THE NEXT LEVEL OF RELAXATION



ROLL-UP GEL PILLOW

01-88-0020

- Versatile design for neck or lumbar support
- Molded silicone gel
- Approximate size: 16" x 10 1/2 "
- Available in Aqua Blue



CONTOURED NECK PILLOW

01-88-0005

- Suction cup attachment
- Polyurethane fill with vinyl cover
- Approximate size: 11" x 5"
- Available in White



DELUXE CONTOURED NECK PILLOW

01-88-0003 & 01-88-0004

- Suction cup attachment
- Polyurethane fill with vinyl cover
- Approximate size: 14" x 6"
- Available in White and Biscuit



SILICONE GEL NECK PILLOW

01-88-0024 & 01-88-0024

- New adhesive technology
- Remove and Reuse, no residue left
- Molded silicone gel pillow
- Approximate size: 12" x 4 1/2 "
- Available in Black and Aqua Blue

WARRANTY ACTIVATION

To activate your warranty, go to www.jettacorp.com/warranty.html
or call (800) 288-7771 and use this lot number:

PLACE STICKER HERE

(800) 288-7771 | WWW.JETTACORP.COM



Installation Instructions

FOR ALL LINES AND MODELS

ADVANTAGE | RAIN SHOWER BASES

CLASSIC | DESIGNER | ELITE

AFFINITY | COSMO | WALK-IN

(800) 288-7771 | WWW.JETTACORP.COM

TABLE OF CONTENTS

GENERAL INSTALLATION INSTRUCTIONS	2
RECEIVING:	2
OPERATIONAL:	2
ELECTRICAL	3
TESTING:	3
ROUGH-IN:	4
OPTIONAL SKIRT INSTALLATION INSTRUCTIONS	5
SKIRTED TUB INSTALLATION INSTRUCTIONS	6
PREPARATIONS	6
ROUGH-IN:	6
INSTALLATION STEPS	6
FREESTANDING INSTALLATION INSTRUCTIONS	8
ROUGH-IN	8
PREPARATIONS	8
INSTALLATION OF FREESTANDING BATHTUBS (1-PIECE) AND DRAIN	9
INSTALLATION OF FREESTANDING BATHTUB (2-PIECE)	10
INSTALLATION OF FREESTANDING BATHTUB CLAWFOOT	11
SHOWER BASE INSTALLATION INSTRUCTIONS	12
PREPERATION	12
INSTALLATION STEPS	12
WALK-IN INSTALLATION INSTRUCTIONS	13
TESTING:	13
LEVELING INSTRUCTIONS:	13
U-BAR INSTALLATION INSTRUCTIONS	13
WALK-IN UNIT INSTALLATION INSTRUCTIONS:	14
WASTE & VENT SYSTEM	14
TROUBLESHOOTING	15

GENERAL INSTALLATION INSTRUCTIONS

RECEIVING:

Immediately upon receiving your Jetta bath, inspect it thoroughly for freight damage. If damage is found, please note on bill of lading and contact JETTA Corporation immediately. The surface should be protected at all times to prevent scratches.

- Check to ensure the bathtub is the unit you ordered and that its dimensions and drain position correspond to your plans.
- Check color match before installation.
- If there is protective plastic sheet covering the surface of your bathtub, it should not be removed until the installation is complete. When necessary during the installation process the plastic can be peeled back to install the drain, overflow and surface mounted plumbing fixtures. The plastic should also be peeled back in areas where it could become snagged during the installation process.
- Do not carry unit by the piping as this may cause leaks.
- Do not sit on the edge on the edge of the bathtub.
- Nothing should be placed in bath that would scratch or break it.
- Workmen in bath should be in stocking feet only.

IMPORTANT: READ AND FOLLOW ALL INSTRUCTIONS PRIOR TO INSTALLATION AND SAVE THESE INSTRUCTIONS FOR FUTURE USE.

OPERATIONAL:

1. Do not permit children to use unit unless they are closely supervised at all times. Supervision is also required when the bath is used by an elderly or handicapped individual.
2. Use this unit only for its intended use as described in the Owner's Manual. Only use attachments recommended by the manufacturer.
3. Do not insert any object into any opening. Do not operate electrical appliances while in or within 5 feet of the bath.
4. Do not operate this unit without the guard over the suction fitting. Long hair must be kept away from the suction screen to avoid entrapment. If entrapment occurs, immediately turn unit off.
5. Do not start pump before unit is filled with water 2" above jets – this will void the warranty.
6. Water level should not exceed the lowest edge of the overflow or controls.
7. The water in a whirlpool should not exceed 40°C (104°F). Water temperatures between 38°C (100°F) and 40°C (104°F) are typically considered safe for healthy adults. Prolonged immersion in hot water may produce hyperthermia. The symptoms of hyperthermia include an increase in the internal temperature of the body, dizziness, lethargy, drowsiness and fainting, which can be fatal. Lower temperatures are recommended for extended use (exceeding 10-15 minutes) for young children.
8. Exposure to very hot water has the potential to cause fetal damage during the early months of pregnancy. Pregnant, or possibly pregnant women should limit water temperature to 38°C (100°F). Consult a physician before using.
9. Persons using medication should consult a physician before using a whirlpool. Medications may induce drowsi-ness, affect heart rate, blood pressure and circulation. The use of alcohol, drugs or medication before or during whirlpool use may lead to unconsciousness with the possibility of drowning.
10. Persons suffering from obesity or with a medical history of heart disease, low or high blood pressure, circulatory system problems, or diabetes should consult a physician before using a whirlpool.

GENERAL INSTALLATION INSTRUCTIONS

ELECTRICAL

WARNING – WHEN USING ELECTRICAL PRODUCTS, BASIC PRECAUTIONS SHOULD ALWAYS BE FOLLOWED, INCLUDING THE FOLLOWING:

DANGER: RISK OF ELECTRIC SHOCK. CONNECT ONLY TO A CIRCUIT PROTECTED BY A GROUND-FAULT CIRCUIT-INTERRUPTER. GROUNDING IS REQUIRED. THE UNIT SHOULD BE INSTALLED BY A QUALIFIED SERVICE REPRESENTATIVE AND GROUNDED. (FOR BUILT-IN AND CUSTOM UNITS) INSTALL TO PERMIT ACCESS FOR SERVICING.

1. This unit must be connected to a supply circuit that is protected by a ground-fault-circuit-interrupter (GFCI). Such a GFCI should be provided by the installer and should be tested on a routine basis. To test the GFCI, push the test button. The GFCI should interrupt power. Push the reset button. Power should be restored. If the GFCI fails to operate in this manner, there is a ground current flowing indicating the possibility of an electric shock. Do not use this unit. Disconnect the unit and have the electrical problem corrected by a qualified service representative before using.
2. Disconnect power before servicing.
3. The motor is supplied with a 30", 14-gauge U.L. approved pigtail. This pigtail is installed at the manufacturers facility and is factory tested and should not be removed or altered under any circumstances. Removal or alteration of this pigtail will void the warranty. The green lead of the pigtail is connected to the ground terminal inside the terminal compartment. To reduce the risk of electric shock, you must ensure that your electric service or supply panel is properly grounded with a continuous green insulated copper wire equivalent in size to the circuit conductors supplying this equipment, but no smaller than No. 12 AWG.
4. A pressure ground connector is provided on the exterior of the terminal box within this unit to permit connection of a No. 8 AWG solid copper bonding conductor between this unit and all other electrical equipment and exposed metal in the vicinity as needed to comply with local requirements.
5. Install to permit access for servicing (for built-in and custom units).
6. Installer / Owner bears all responsibility to comply with all state and local codes when installing this product.

TESTING:

Water test your unit prior to installation. Set the tub on a level surface where it can be drained after testing. Insert drain fitting and fill to the overflow. Make sure all fittings, through walls and piping are water tight. While each unit is leak tested at the factory, the process of shipping and handling may loosen joints. If there are leaks, mark the spot(s), drain and repair with GE Silicone Sealer (fiber glass to PVC) or PVC cement (PVC to PVC). Repeat test when dry.

GENERAL INSTALLATION INSTRUCTIONS

ROUGH-IN:

Test fit the tub and verify dimensions. Your Jetta bath should be installed in a bedding compound, preferably a mortar mix or thin set, which should be distributed under the base to provide maximum support and even weight distribution. Do not use foam, sand or drywall mud. When leveling, prepare a bed of moist mortar in the area where bath is to be installed. Place equally spaced mounds of bedding compound, about one foot apart, 2" to 4" tall - this should be about the diameter of a three-pound coffee tin (8"-10"). When the bottom of the tub comes in contact with the bedding compound, it should compress the mounds to a 1" to 3" layer while the tub should lightly rest on top of the tub deck. Once the bedding compound dries, all the weight will be carried through the floor of the tub, not suspended by its lip. Carefully level the unit, ensuring that uniform support is given to all areas of the base and that no portion of the lip is bearing weight.

DO NOT SUPPORT THE WEIGHT OF THE BATH BY THE RIM! Your Jetta bath has a pre-leveled lip that accounts for the sloped floor towards the drain. **DO NOT REMOVE** the 1" x 1" drain board attached to the bottom of the tub. It is recommended that plastic is laid between the bedding compound and the bath, in case removal of the bath is ever necessary.

If the pump is removed for any reason, use only union connections to reattach. Do not overtighten. Make sure the O-rings on the pump are in place. Hand tighten pump fittings. Do not use a wrench, channel locks, or pipe dope (Teflon paste).

Pump must be located between 1/2" to 1 1/2" above suction fitting. Make sure suction line will drain from pump to bath. A minimum access panel of 14" x 10" must be provided in case the pump or air blower needs to be serviced at a later date.

IMPORTANT: MANUFACTURER WILL NOT BE LIABLE FOR THE REMOVAL OR RE-INSTALLATION OF THE BATHTUB IF THERE IS A FAILURE TO FOLLOW THE MANUFACTURERS RECOMMENDED PRE-INSTALLATION AND INSTALLATION PROCEDURES, FAILURE TO FOLLOW THE MANUFACTURERS RECOMMENDATIONS COULD RESULT IN THE WARRANTY BEING VOIDED.

OPTIONAL SKIRT INSTALLATION INSTRUCTIONS

OPTIONAL SKIRT:

1. The skirt may need to be trimmed to size. Take the measurements of the skirt opening and compare those of the skirt itself to determine if the skirt must be trimmed to fit. If so, mark the dimensions on the skirt and trim the skirt on the bottom and sides (do not trim the top of the skirt) and cut to within 1/8" of the required dimensions using a circular saw with sharp tooth blade. Using a belt sander is recommended to finish trimming the sides and bottom of the skirt to the exact size of the opening.
2. To create a positive stop for the skirt, nail, glue or screw 2x2" or 2x4" wood blocks on both side walls and along the full length of the front floor section (parallel to tub lip). The wood blocks must be mounted securely against a wall or stud wall framing and the floor.
3. The top of the skirt is notched. Foam blocks are glued to the top backside of the skirt (section that is notched) and will compress to hold the skirt against the bathing well of the tub. Check the underside of the tub lip for smoothness. There may be fiberglass chop that requires sanding, so the skirt will fit snugly in place. Slide the notched top edge of the skirt under the lip of the tub. Move the bottom section of the skirt in place until it is resting against the wood blocks. Verify the vertical edge of the skirt is perpendicular to the floor.
4. Included with the skirt are two screws and decorative caps that cover/conceal the screw head and are color matched to the acrylic. Drill two (2) screw holes in the bottom of the skirt to protect the acrylic from cracking, position to align with wood block. Screw both lower ends of the skirt through the decorative caps, through the acrylic and into the wood blocks to hold the skirt securely in place.

Note: the skirt is not marked where the screws should be positioned as application will dictate position.

Installer may then seal the sides and floor with caulk or silicone if so desired.

Parts included for optional skirt installation:

- (1) skirt
- (2) screws
- (2) decorative caps
- (1) instruction sheet

Parts / tools needed for optional skirt installation that are NOT included:

- circular saw with sharp tooth blade and a belt sander
- drill
- 2x2" or 2x4" wood blocks
- caulk or silicone
- screw driver
- tape measure
- square / level

IMPORTANT: MANUFACTURER WILL NOT BE LIABLE FOR THE REMOVAL OR RE- INSTALLATION OF THE BATHTUB IF THERE IS A FAILURE TO FOLLOW THE MANUFACTURERS RECOMMENDED PRE-INSTALLATION AND INSTALLATION PROCEDURES, FAILURE TO FOLLOW THE MANUFACTURER'S RECOMMENDATIONS COULD RESULT IN THE WARRANTY BEING VOIDED.

SKIRTED TUB INSTALLATION INSTRUCTIONS

PREPARATIONS

Before installing a new Jetta bathtub, we strongly recommend following the installation check list and hiring a certified plumber to handle the installation.

REQUIRED TOOLS

- Levels
- Goggles
- Tape Measure
- Caulking Gun
- Conventional woodworking tools and materials
- Drop cloth
- 1/8" Spacers
- Plastic film (optional)

REQUIRED MATERIALS

- Silicone bathroom caulking (mildew resistant)
- Mortar cement
- Visually inspect the bathtub to make sure it has not been damaged during transport. In case of damage, do not proceed with the installation.

ROUGH-IN:

- Make sure the bathtub is the model that you ordered, that its dimensions are correct, and that the location of the drain corresponds to the plans.
- Your Jetta bath should be installed in a bedding compound of mortar mix or thin set which should be distributed under the base to provide maximum support and even weight distribution. Do not use foam, sand, or drywall mud.

INSTALLATION STEPS

1. Refer to the specification sheet for tub measurements, Construct a plumb alcove out of studs.
2. Install the rough plumbing.
3. Install the drain to the bath.
4. To prevent water absorption, lay plastic film on wooded subfloors. (Optional)
5. Your Jetta bath should be installed in a bedding compound, preferably a mortar mix or thin set, which should be distributed under the base to provide maximum support and even weight distribution. Do not use foam, sand or drywall mud. When leveling, prepare a bed of moist mortar in the area where bath is to be installed. Place equally spaced mounds of bedding compound, about one foot apart, 2" to 4" tall - this should be about the diameter of a three-pound coffee tin (8"-10"). When the bottom of the tub comes in contact with the bedding compound, it should compress the mounds to a 1" to 3" layer while the tub should lightly rest on top.

SKIRTED TUB INSTALLATION INSTRUCTIONS

6. Apply a generous amount of construction adhesive to the bath feet or base.
7. Lift the bath into place. Carefully level the unit, ensuring that uniform support is given to all areas of the base and that no portion of the lip is bearing weight.

DO NOT SUPPORT THE WEIGHT OF THE BATH BY THE RIM! DO NOT REMOVE the 1" x 1" drain board attached to the bottom of the tub.

8. Apply the weight evenly to the bath basin until the mortar sets. Once the mortar dries, all the weight will be carried through the floor of the tub, not suspended by its lip.
9. Connect the bath drain to the drain pipe. Position a protective liner in the bath basin.
10. Drill small holes through the flange at the studs. If there are gaps, fill them with a shim.
11. Secure the flange to the studs with galvanized nails or screws.
12. Secure ¼" furring strips to the studs to be flush with the bath flange.
13. Install water-resistant wallboard over the framing.
14. Apply a 1/8" bead of 100% silicone sealant along the seams.
15. Install the finished wall and deck to within 1/16" of the bath rim.
16. Apply 100% silicone sealant around the bath along the finished walls and deck.

IMPORTANT: MANUFACTURER WILL NOT BE LIABLE FOR THE REMOVAL OR RE-INSTALLATION OF THE BATHTUB IF THERE IS A FAILURE TO FOLLOW THE MANUFACTURERS RECOMMENDED PRE-INSTALLATION AND INSTALLATION PROCEDURES, FAILURE TO FOLLOW THE MANUFACTURERS RECOMMENDATIONS COULD RESULT IN THE WARRANTY BEING VOIDED.

FREESTANDING INSTALLATION INSTRUCTIONS

ROUGH-IN

Test fit the tub and verify dimensions. Carefully level the unit, ensuring that uniform support is given to all the feet and that no portion of the tub shell is bearing weight.

SITE PREPARATION:

- The site should be cleared of debris and vacuumed. This will ensure that the bathtub is leveled properly.
- Check if the floor is leveled and solid. The level should be in a range that can be compensated for by the use of adjustable feet. An average sized bathtub can weigh as much as 1000 lbs when full, the floor must be able to support this weight.
- An opening of 6" x 12" should be provided in the floor for the bathtub drain and overflow. Make sure there are no obstructions in this space.
- The plumbing rough-in for both the drain and the supply lines should be completed by a licensed plumber before the bathtub is moved into its final position.

PROTECTIVE FOAM PACKAGING:

The adjustable feet are protected with foam packaging around each foot to ensure the quality of the bathtubs during transportation. Remove foam protectors prior to installation.

PREPARATIONS

Before installing a new Jetta Cosmo bathtub, we strongly recommend following the installation check list and hiring a certified plumber to handle the installation.

REQUIRED TOOLS

- Levels
- Goggles
- Tape Measure
- Caulking Gun

REQUIRED MATERIALS

- Silicone bathroom caulking (mildew resistant)
- Visually inspect the bathtub to make sure it has not been damaged during transport. In case of damage, do not proceed with the installation.
- Make sure the bathtub is the model that you ordered, that its dimensions are correct, and that the location of the drain corresponds to the plans.
- To protect the bathtub during installation, cut a piece cardboard from the packaging and place it in the bottom of the bathtub.
- If the bathtub is equipped with adjustable metal legs, they must first be installed by screwing them into the metal opening beneath the bathtub.

FREESTANDING INSTALLATION INSTRUCTIONS

INSTALLATION OF FREESTANDING BATHTUBS (1-PIECE) AND DRAIN

1. Temporarily position the bathtub in the desired location, ensuring that the drain hole is aligned to the floor drain and then draw the contour of the bathtub on the ground. If the floor drain is not installed yet, trace its location through the hole of the bathtub, then move the bathtub to a safe place, so as to install floor drain according to guidelines. Reposition the bathtub and ensure that the trace lines are followed.
2. Check the level and adjust if necessary by screwing or unscrewing the feet beneath the bathtub (maximum adjustment of 1 3/4") and ensuring that the bathtub is always resting on all four feet while minimizing the space between the skirt and the floor (the skirt can touch the floor but shall in no way support the weight of the bathtub).
3. Lock the bathtub feet into position by tightening the adjoining nut once an accurate, acceptable level is confirmed.
4. Lay the bathtub on its side, having previously laid cardboard packaging on the ground to protect the surface of the bathtub. Be sure to use a piece of cardboard without staples to avoid damaging the surface of the bathtub.
5. Temporarily install the drain assembly of the bathtub.
6. Place the bathtub back into position on the previously traced outline while ensuring that the drain end fits into the floor drain and is held in place for the next step.
7. Unscrew the rings of the overflow valve and then lift the bathtub and lay it on its side making sure not to move the drain, specifically the floor drain.
8. Tighten the seal ring of the floor drain to the end of the drain.
9. Apply a bead of silicone to the entire circumference of the skirt and the bathtub feet. We also recommend setting a circle of silicone to seal the drain and overflow.
10. Place four pieces of wood 3/4" thick inside the footprint on which to temporarily rest the bathtub.
11. Raise the bathtub and then put it back down again, ensuring alignment over the vertical drain, without moving the drain and making sure the bathtub rests on the wooden blocks.
12. Remove the wooden blocks one by one to correctly place the bathtub in its resting place aligned to the drain.
13. Tighten all drain and overflow connections properly.
14. If necessary, add silicone to the location of the pieces of wood, clean surplus and erase the trace marks on the ground.
15. Leave the bathtub in this position for at least 24 hours before use.
16. Water test the bathtub for leaks.

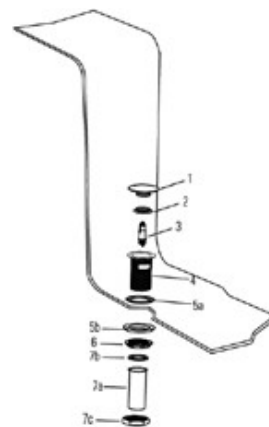

- 1- Plug
- 2- Cap Seal
- 3- Opening Mechanism
- 4- Strainer
- 5a- Baque putty
- 5b- Seal
- 6- Mounting Nut
- 7a- Drain Pipe (1.5")
- 7b- Gasket
- 7c- Tightening nut

FREESTANDING INSTALLATION INSTRUCTIONS

INSTALLATION OF FREESTANDING BATHTUB (2-PIECE)

For a bathtub with a contour skirt, we suggest that you follow the instructions below. It is recommended that the installation be done by two people.

The bathtub has been leveled in factory. If an adjustment is necessary, you can use the adjustable feet by loosening the locknut on each foot, but they must be relocked in position before the final installation.

1. Temporarily position the entire bathtub in the desired location. If the drain is not preinstalled, mark its location on the floor so that you can reposition the bathtub correctly in the following steps (Figure A). Using a washable marker, draw two lines from the edge of the bathtub to the skirt (Figure B) to establish a reference point for Step 5.

An opening of 6" x 12" inches needs to be cut into the floor for the bathtub drain and overflow (see figure below). Make sure that there are no obstructions in this space.

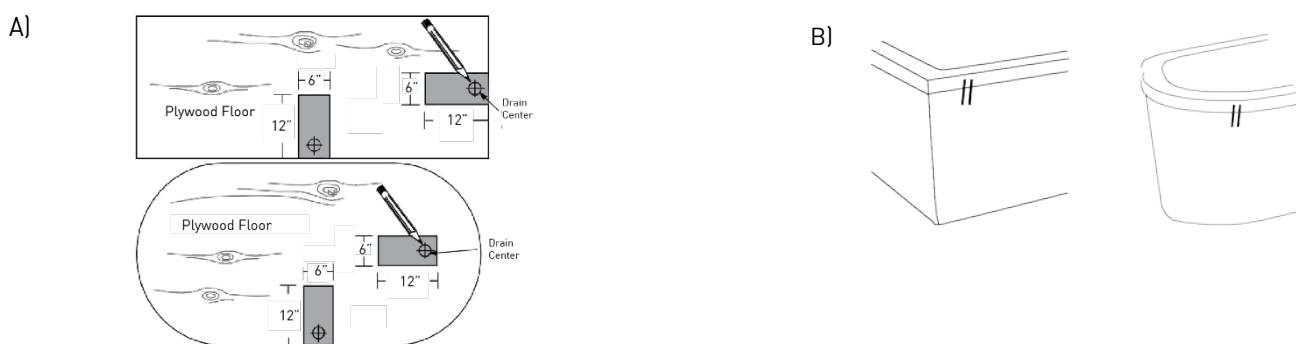

2. Remove only the bathtub, being careful to not move the skirt. Next, draw the interior outline of the skirt on the floor with a lead pencil to designate skirt location. (Figure 7)
3. Remove the skirt and reposition only the bathtub according to the previously drawn lines.
4. Apply a thin line of silicone under the skirt and put it into place.
5. Position the bathtub, integrate the bathtub into the skirt. Make sure that the two reference lines drawn are well aligned.

Note: The bathtub must rest on its feet and skirt. The feet should be in contact with the floor and the skirt with the edge of the bath at all times.

6. Leave the bathtub in this position for at least 24 hours.

NOTES:

We recommend the two following methods for future service access:

- A) Cut an access panel in the floor under the bathtub if circumstances allow.
- B) Remove the bathtub from the skirt if required for maintenance.

The structure of this style of bathtub is not designed to sit on the edge, the acrylic skirt and the tub itself may crack. A tape with foam can be installed between the skirt and the tub to avoid squeaking noise.

FREESTANDING INSTALLATION INSTRUCTIONS

INSTALLATION OF FREESTANDING BATHTUB CLAWFOOT

READ ALL OF THE INSTRUCTIONS BELOW AND FOLLOW ALL LOCAL PLUMBING AND BUILDING CODES.

Unpack and inspect the clawfoot attachments for any shipping damages and ensure no pieces are missing.

If any damages are discovered, DO NOT INSTALL.

Before installing, we suggest having a blanket or soft surface to avoid scratches while the tub is turned upside down while attaching the feet.

REQUIRED TOOLS & MATERIALS

- (1) Long Bracket
- (2) Short Brackets
- (4) Bolts
- (10) Nuts
- (10) Washers
- 17mm & 19mm Sockets
- Socket Wrench

NOTE: STEPS 1-5 ARE STPS TO BE TAKEN FOR THE BRACKETS CLOSEST TO THE DRAIN. STEPS 6-10 ARE FOR THE SINGLE BRACKET ON THE BACK END OF THE TUB. STEPS 11-14 INCLUDE THE INSTALLATION OF THE CLAWFOOT ONCE THE BRACKETS HAVE BEEN ADDED.

INSTALLATION STEPS

1. While the tub is upside down, take off the plastic caps at each foot location covering screw threads. There will be 1 washer and 1 nut underneath the plastic caps. Take each of these off.
2. Place the 2 small brackets down so that the screws are protruding from the 2 elongated holes in each bracket and center them evenly.
3. By hand, thread 1 of each washer and nut down onto all 4 bolt threads.
4. Taking one of the clawfeet, line the threaded hole in the bracket up with the hole on the back of the leg and ensure that it will fit properly. The bracket can be adjusted slightly if needed.
5. When you've made sure the bracket is in the proper position for the installation, tighten down both nuts with a 17mm socket.
6. While the tub is upside down, take off the plastic caps at each foot location covering screw threads. There will be 1 washer and 1 nut underneath the plastic caps.
7. Place the long bracket down so that two screws are protruding from the 2 elongated holes in the bracket and center the bracket evenly.
8. Thread the washer and nut down on both ends of the bracket, but only hand tighten these for now.
9. Taking one of the clawfeet, line the threaded hole in the bracket up with the hole on the back leg and ensure that it will fit properly. The bracket can be adjusted slightly if needed. *Repeat for opposite leg.*
10. When you've made sure the bracket is in the proper position for the installation, tighten down both nuts with a 17mm socket.
11. Supplied is a washer and bolt for each leg. Place 1 large washer on a nut, this will be needed in later steps.
12. To attach the clawfoot, place it on the tub and line the threaded hole on the bracket to the elongated hole on the back of the clawfoot.
13. Take the nut with a washer on it that was prepared in the steps previously and hand tighten the leg down. *(Be sure the leg fits properly and is level before continuing)*
14. Once the leg is positioned and leveled for installation, tighten the bolt down with a 19mm socket.



REPEAT STEPS 11-14 FOR EACH REMAINING CLAWFOOT

NOTE: EACH LEG HAS AN ADJUSTABLE LEVELER. A 17MM SOCKET IS REQUIRED TO MAKE ADJUSTMENTS.



SHOWER BASE INSTALLATION INSTRUCTIONS

PREPERATION

READ ALL OF THE INSTRUCTIONS BELOW AND FOLLOW ALL LOCAL PLUMBING AND BUILDING CODES.

Unpack and inspect the shower base for any shipping damages and ensure no pieces are missing.

If any damages are discovered, DO NOT INSTALL.

REQUIRED TOOLS & MATERIALS

- | | |
|--------------------|---------------------------------------|
| ○ Safety glasses | ○ Pipe wrench |
| ○ Drill | ○ Set square |
| ○ Screwdriver | ○ Drill bit |
| ○ Paper and pencil | ○ Silicone sealant (mildew resistant) |
| ○ Tape measure | ○ Construction glue |
| ○ Level | ○ Shims (cedar shingles) |
| ○ Hammer | |

Ensure plumbing rough-in for both the drain and the supply lines are completed according to your shower base's dimensions.

The floor area where your shower will be installed must be structurally sound and strong enough to hold the shower base and an adult's weight. Also make sure that the walls and floor are square, plumb, and level. If need by, level the floor with floor leveler.

Sweep the floor to remove construction debris and vacuum to remove all remaining dust.

If renovating, remove all existing wall material in order to install shower base directly on wall studs.

Ensure that the wood frame has the appropriate dimensions.

If you plan on installing a door, you will also need to plan studs to receive the fastener screws when installing the jams. Please refer to the installation guide provided with the door.

All plumbing rough-in for both the drain and the supply should be completed before installing the shower base.

INSTALLATION STEPS

Ensure walls and floor are square, plumb and level and that the waste pipes are well positioned. Position the unit in the prepared location and adjust level with wood shims or mortar. It will be easier to adjust the tray if you have access to it from the outside of the formwork. Before proceeding to the final installation, verify drainage by pouring water in the shower base.

Tray with tiling flange on 3 sides and corner tray

The sides with tiling flange must lean against the 2 x 4s. (see fig)

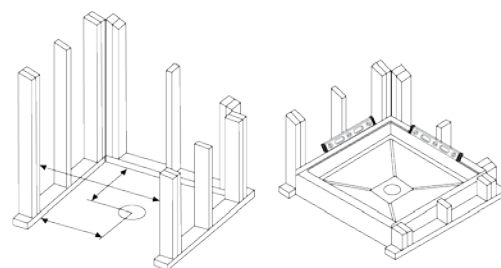

Ceramic tiles must be flush with the base's interior walls, the walls must be perfectly square and the tray perfectly level in order to be able to adjust the doors correctly. (see fig)

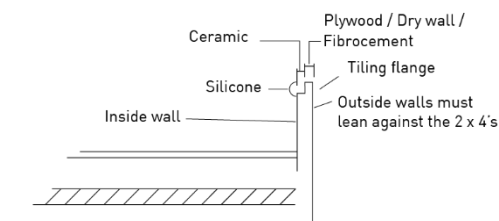

IMPORTANT!

Note that to install all basic shower models, the sides and feet of the base must be properly supported. It is strongly recommended that you rest the base on a mortar bed, make a structure to support the center (drain) of the base, and level the floor using a floor leveler.

WALK-IN INSTALLATION INSTRUCTIONS

TESTING:

Water test your unit prior to installation. Set the tub on a level surface where it can be drained after testing. Fill to the overflow. Make sure all fittings, through walls and piping are water tight. While each unit is checked at the factory, the process of shipping or improper handling may have loosened the joints. If there are leaks, mark the spot(s), drain and repair with GE Silicone Sealer (fiber glass to PVC) or PVC cement (PVC to PVC). Repeat test when dry.

The air switch must be located on or near bath, with access available. Check to ensure that the air hose is plugged into the switch that is located at the back of the rectangular box on top of the motor. For additional safety, a ground-fault circuit-interrupter must be added.

Faucets may be installed through the wall or mounted on the bath. Insert drain and overflow to waste line. After installation, fill the bath and let stand 3 - 4 hours (operating it for at least 30 minutes) to double check that it is still water tight. Inspect tub completely (around pump and or blower, all plumbing fittings and doors for leaks) any defect must be reported prior to installation in order to have it covered under warranty.

Check to ensure that your installation will conform to all applicable codes and secure necessary permits. All electrical and plumbing connections should be made by qualified electricians and plumbers.

LEVELING INSTRUCTIONS:

1. Feet are extended for shipping purposes to provide clearance and protection of the front skirt. The tub must be reset to proper installation height by installer.
2. Raise the two center feet so that tub rests only on the four corner feet.
3. Raise the corner feet to lower tub to desired height and level tub in both directions.
4. After the tub has been water tested and all plumbing connections are made up, verify tub level and lock the four corner feet in position.
5. Lower the two center feet so they firmly contact the floor and tighten in place.

SYSTEM TEST: AFTER INSTALLATION MAKE SURE ALL PLUMBING CONNECTIONS AND HYDRO MASSAGE AND AIR MASSAGE SYSTEM CONNECTIONS ARE CORRECTLY INSTALLED, RUN THE FOLLOWING TESTS:

1. Before filling the tub with water, be sure to remove all loose debris from tub. Wipe down the door seal using a damp cloth, as well as the surface in the door jamb that will come in contact with the door seal.
2. Fill the tub to the overflow and check for leaks. Check by hand where visual verification is not possible.
3. Turn the pump and or blower on and let run for at least 30 minutes. Check for leaks while the system/systems are running and again after you turn them off. Check by hand where visual verification is not possible.

U-BAR INSTALLATION INSTRUCTIONS

- For ease of access, mount the Grab Bar prior to Walk-In Tub placement.
- Using the accompanying hardware, slide the Chrome decorative ring onto the bolts on the Grab Bar.
- Mount the Grab Bar into the predrilled holes on the deck of the tub.
- Under the deck, slide the washers onto the Grab Bar bolts and tighten the Grab Bar using the provided nuts.

NOTE: DO NOT OVER TIGHTEN as this may cause damage to the tub surface. Not using washers at install may cause injury due to failure of the grab bar.

WALK-IN INSTALLATION INSTRUCTIONS

WALK-IN UNIT INSTALLATION INSTRUCTIONS:

1. Bathtub must be set on a solid flat surface and leveled in both directions. (All six (6) adjustable feet must come in contact with the floor). Bathtub **MUST** be leveled using a 2' - 0" level both ways on the top deck of the Bathtub only.
2. Plumbing hardware (fill valve, hoses, and reverse drain) should be installed prior to setting tub in-place.
3. Use union connections only for the pump. Do not overtighten. Make sure the O-rings on the pump are in place. Hand tighten pump fittings. Do not use a wrench, channel locks, or pipe dope (Teflon paste).
4. The Filler / Extension panel(s) are used to extend the overall Bathtub to 60".
5. The Door Drain fitting (precut to fit) is to be installed between the drain shoe and the Waste & Overflow tee-or- in reverse drain application, between the waste and overflow piping.

WASTE & VENT SYSTEM

For optimum drain performance, it is recommended to replace the trap arm and vent tee with a 2" x 1 1/2" x 2" vent tee and a 2" trap arm with a 2" 'P' trap and 1 1/2" bushing. If this is not possible, replace the existing 1 1/2" trap arm and 'P' trap. If neither of the above options is possible, it is critical to 'Roto Rooter' or snake out the 'P' Trap and trap arm for at least 10'-0" from the 'P' trap.

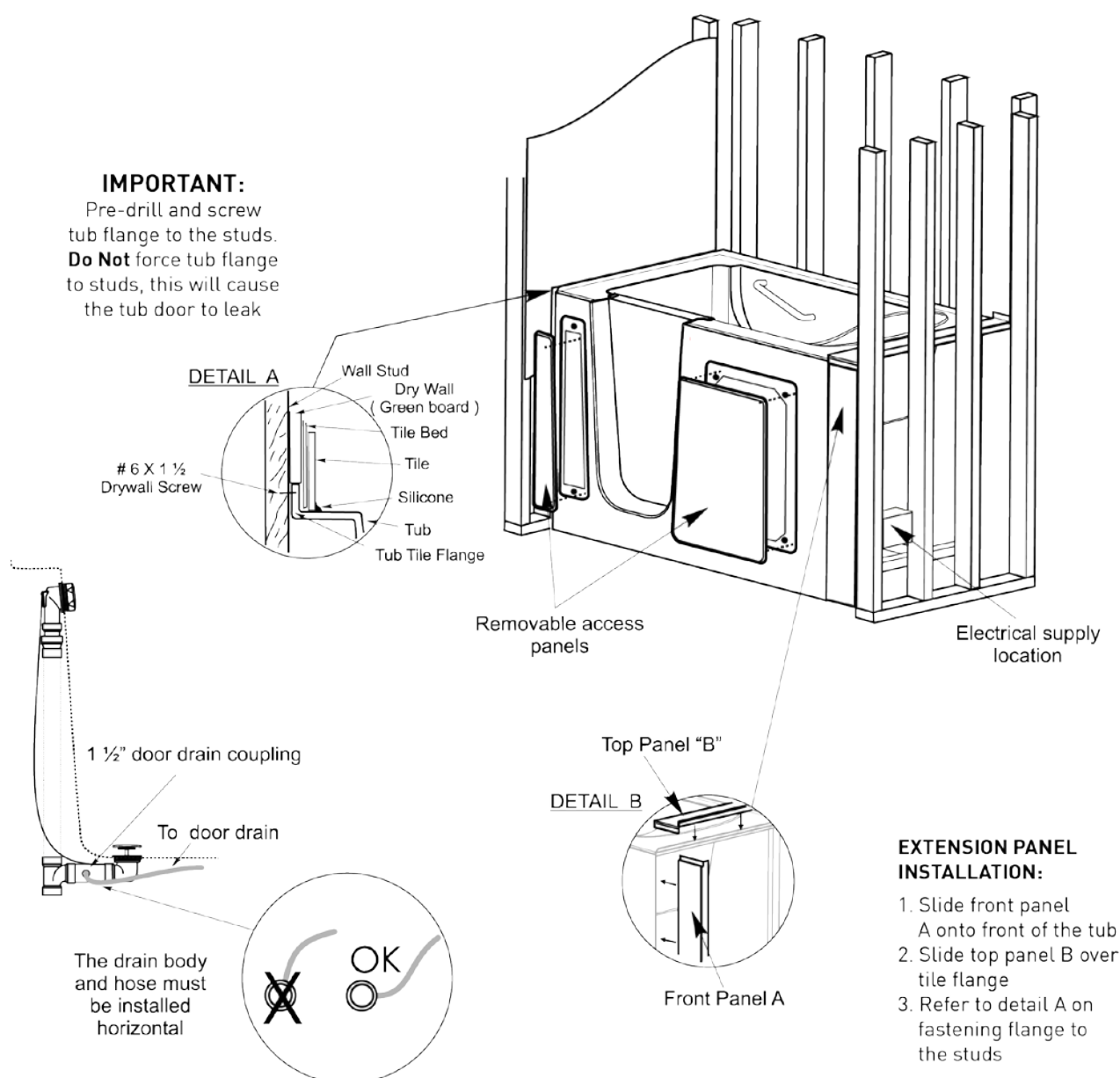

TROUBLESHOOTING

Why will my jet motor not turn on or off?

The GFCI could be tripped. Confirm that the receptacle is working by plugging in a hairdryer or light. If the receptacle is operational, check to ensure that the red tubing is attached firmly to the bottom of the On/Off switch button body as well as to the back of the motor. The On/Off button is operated by a puff of air traveling down this line.

Why is the same amount of water not coming out of all of my jets?

All Elite, Designer, Classic and Walk-In tubs have jets with adjustable water volume control to provide specific intensity to each area of the body. The intensity can be controlled by turning the jet to the right for increased water flow or to the left for decreased water flow. Please note that our Advantage and Affinity lines do not have adjustable water volume jets.

Can I adjust the whirl pattern coming from the jets on the back of my tub?

Jetta Designer and Elite baths come standard with rotational jets at the back of the tub. These jets are designed to disperse water in a whirl pattern. To reduce the whirl pattern, use your finger to adjust the center of the jet nozzle to the center of the jet body. To increase the whirl pattern, move the jet nozzle to the outer ring of the jet body. Please note that our Classic, Walk-In, Advantage and Affinity lines do not have rotational jets.

Why does the water flow not increase through the jets even though I am adjusting them?

There could be debris caught in the jet. The jet body on our Classic, Designer, Elite and Walk-In tubs can be removed by rotating to the left until the tabs clear the openings. When reinstalling the jet, insert the tabs into the openings and turn to the right until you hear the jet click into place. Please note that the jets on our Affinity and Advantage lines are unable to be adjusted and/or removed for cleaning.

Can I remove my jets for cleaning?

The jets in Jetta's Classic, Designer, and Elite tubs can be removed and placed in the dishwasher for cleaning. To remove the jets, turn the outer ring counter clockwise past the point of resistance until you hear a click. Pull the jet straight out to remove. To reinstall the jet, insert the jet body into the housing and turn to the right until you hear a click.

Can I use Epsom or bath salts, bubble bath or bath oils in my tub?

We do not recommend using salts with the whirlpool or air feature as the salt crystals may get stuck in the jets, air holes, plumbing lines or pump. Additionally, the acrylic may discolor due to use of bath salts.

We recommend using only bubble bath that is water soluble with the soaker hydrotherapy only so as not to leave a residue in the plumbing or air lines of your tub. We do not recommend using bubble bath or any oil-based bath products while your whirlpool or air system is in use.

Why will my air blower not turn on?

The GFCI could be tripped. Confirm that the receptacle is working by plugging in a hairdryer or light. If the outlet is operational, unplug the blower from the GFCI outlet under your tub. Ensure that the black cable is securely fastened to the back of the keypad as well as the back side of the blower. The black cable needs to be plugged into the far right opening as you are facing the back of the blower. Look into the plug on the cable and confirm there are no bent pins inside the plug. Plug the blower back into the GFCI outlet. Reset the keypad by pressing and holding the top two buttons simultaneously for 10 seconds. If the reset was successful, all of the lights on the keypad should be off after the initialization sequence concludes.

How do I adjust the speed of the bubbles on my air tub?

The speed adjustment is located on your keypad. Press and hold the + or – keys to increase or decrease the speed of the bubbles.

Why is my air blower not running at an even speed?

Jetta air tubs come standard with three modes. Pressing the blower button on your keypad once will give you Continuous Mode. Pressing the blower button twice will give you Pulse Mode. Pressing the blower button three times will give you Wave Mode.

Why does my air blower turn on after I am out of the bath?

Jetta air tubs come equipped with an automatic purge or dry cycle. This keeps the injector lines clean and dry. The cycle is initiated automatically 20 minutes after use and has a cycle time of 2 minutes.

TROUBLESHOOTING

Should I run the purge cycle even if I do not use the air blower?

Yes. Jetta recommends that you turn the blower on then back off to set the purge cycle to ensure that the lines stay clean and dry.

What should I do if the light in my air tub will not turn on?

The light on air or combo tubs is operated by the keypad. Check to ensure that the gray cable coming from the back of the light cup is plugged into the middle outlet on the back of the blower

If unit is within the limited factory warranty, contact Jetta Corporation at (800) 288-7771 with your purchasing information on hand so we may serve you better.

Visit WWW.JETTACORP.COM/FAQs for additional troubleshooting tips.

425 Centennial Blvd
Edmond, OK 73013

LOCAL (405) 340-6661
TOLL FREE (405) 340-6661
SALES@JETTACORP.COM



WWW.JETTACORP.COM